

FUNCTIONING

This launcher has a semi-automatic trigger-cocking mechanism. Pull trigger and cylinder operates automatically (double action system). Launcher can however also be cocked by hand (single action system).

Do not pull trigger with empty cylinder; the crimped blank cartridge seats and the firing pin will be damaged.

**SAFETY**

When cylinder is swung out or not fully snapped back the trigger mechanism is blocked. When the hammer is cocked, the cylinder cannot be swung out. The built-in automatic safety system prevents cartridges being fired inadvertently.

LOADING

Only crimped blanks to be used with this launcher

Always point muzzle to the floor when loading crimped blanks. Push release on the left side of the frame forward (to disengage cylinder) and swing cylinder out to the left. Insert crimped blanks and swing cylinder back into original position.

FIRING

Dry Firing (with no blanks in the chamber) will permanently damage launcher.

This launcher is only suitable for firing blanks but is not suitable for firing pyrotechnic scare cartridges.

REMOVING OF FIRED SHELLS

Swing out cylinder as described above. When extractor (cylinder axle) is pushed backwards the seven shells are ejected simultaneously.

CLEANING

After each use clean crimped blank chamber, muzzle adaptor and barrel with a 6mm bore brush and water. Dry all parts thoroughly after cleaning. Proper maintenance will increase the efficiency and life of the launcher.

NB: *It is extremely important, that launcher and chamber be kept very clean, especially after heavy use, as it is possible for flash of blank to be impeded by carbon build up and flash backwards.*

SAFETY INSTRUCTIONS

- **Operator must only fire this launcher in area clear of all personnel. Personnel should be a minimum of 5 meters behind launcher operator. Always fire at a 45-degree angle above the ground.**
- **Do not make any modifications to any components of this launcher.**
- **Never load or fire this launching device from a vehicle or vessel. Do not fire at humans, animals, buildings, and dry fields or at any flammable materials or liquids.**
- **Always wear a hardhat, eye, and ear protection when using or handling this launching device.**
- **Never store launcher with crimped blanks inserted.**
- **This device is intended solely for wildlife management and control. The proper and safe use of this device is the sole responsibility of the operator/owner. The seller assumes no responsibility or liability for the improper or illegal use, resale, physical injury or property damage resulting from the deliberate or accidental discharge, modifications to the device or cartridges, careless operation, and launcher maintenance neglect. The seller guarantees care in manufacture but assumes no further responsibility.**
- **Only mature, responsible adults who have a clear understanding of the functions of this device and a working knowledge should operate this tool. Persons under 18 years of age should not operate this device.**
- **Always keep this instructional sheet with the launcher.**
- **This launcher is NOT a firearm, it is a powder-actuated tool.**
- **Failure to comply with these safety instructions could result in serious injury or death**

****IF UNCLEAR ON ANY OF ABOVE TOPICS, PLEASE CONTACT MARGO SUPPLIES LTD. ****

RG 56 Signal Revolver

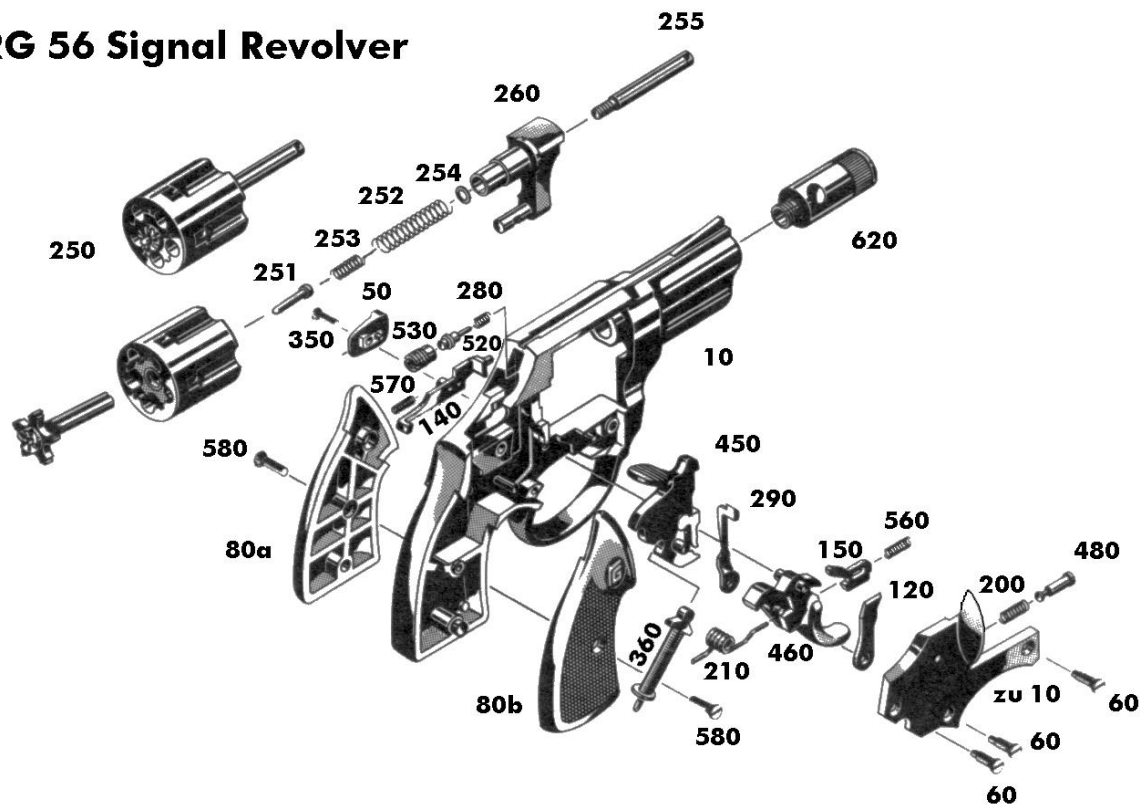

Diagram #	ID #	Description	Diagram #	ID #	Description
10 ~	895339	Revolver Frame	260 *	881939	Cylinder Holder
50 ~	678661	Cylinder Release	280 ~	368443	Firing Pin Spring
60 ~	680480	Countersunk Screw	290 ~	678679	Cocking Lever
80a ~	687808	Left Handle Grip	350 ^	671097	Release Screw
80b ~	698635	Right Handle Grip	360 ~	385148	Pressure Shuttlecock
120 *	881935	Carrying Blade	450 ~	678680	Hammer
140 ~	678670	Security Lever	460 ~	678697	Trigger
150 ^	639196	Rest Blade	480 ^	057092	Cylinder Latch Pin
200 ^	005591	Pressure Spring	520 *	881944	Firing Pin
210 ^	806286	Trigger Spring	530 ~	684205	Firing Pin Shell
250 *	881942	Cylinder (complete)	560 ^	324461	Pressure Spring
251 ~	678681	Interlock Pin	570 ^	057096	Security Lever Spring
252 ~	678698	Cylinder Spring (large)	580 ^	306649	Handle Grip Screw
253 ~	678682	Cylinder Spring (small)	620 *	893450	Muzzle
254 ~	678671	Washer	zu 10 ^	012968	Frame Plate
255 ~	678685	Extractor (cylinder axle)		010546	Cylinder Brush

* Indicates RG 46/56 ~ Indicates RG 46/56/59 ^ Indicates RG 46/56/59/69/89/99